

www.cemb-usa.com

SMT 30



ENGINEERED IN ITALY
MADE FOR THE USA

SEMI-AUTOMATIC
TRUCK TIRE
CHANGER



CEMB

SMT30



- **SELF-CENTERING CHUCK:** The hydraulic chuck has working capacity from 14" to 30" and it performs a 1-speed rotation in both directions. The 4 self-centering clamps with adjustable pressure have been studied to allow several clamping solutions in order to assure a perfect locking of any rim's shapes and profiles.



- **TOOL-HOLDER CARRIAGE:** Automatic translational movement of the tool-holder carriage controlled by the on-purpose control unit. Manual tool arm movement (translational) with quick unlocking system.



Universal electro-hydraulic truck tire changer designed for tubeless or inner tube tires of trucks and buses with a maximum diameter of 1640 mm and a maximum width of 850 mm. Conceived for **intensive and professional purposes**, the self-centering chuck locks grooved and split ring rims from 14" to 30".



- **TOOL-HOLDER ARM:**
Manual tool-holder arm lifting and tool rotation.



- **SAFETY DEVICES:** The hydraulic distribution is equipped with a valve, which regulates the operating pressure of the chuck, allowing to safely operate on all types of aluminum and alloy rims, particularly thin or fragile.



- **CONTROL UNIT:** The machine is equipped with a low voltage portable control unit, easily movable inside the working area. The rational lay-out of control levers, buttons and pedals prevents the operator from making accidental and dangerous operational errors.

STANDARD ACCESSORIES



CEMB

TECHNICAL DATA

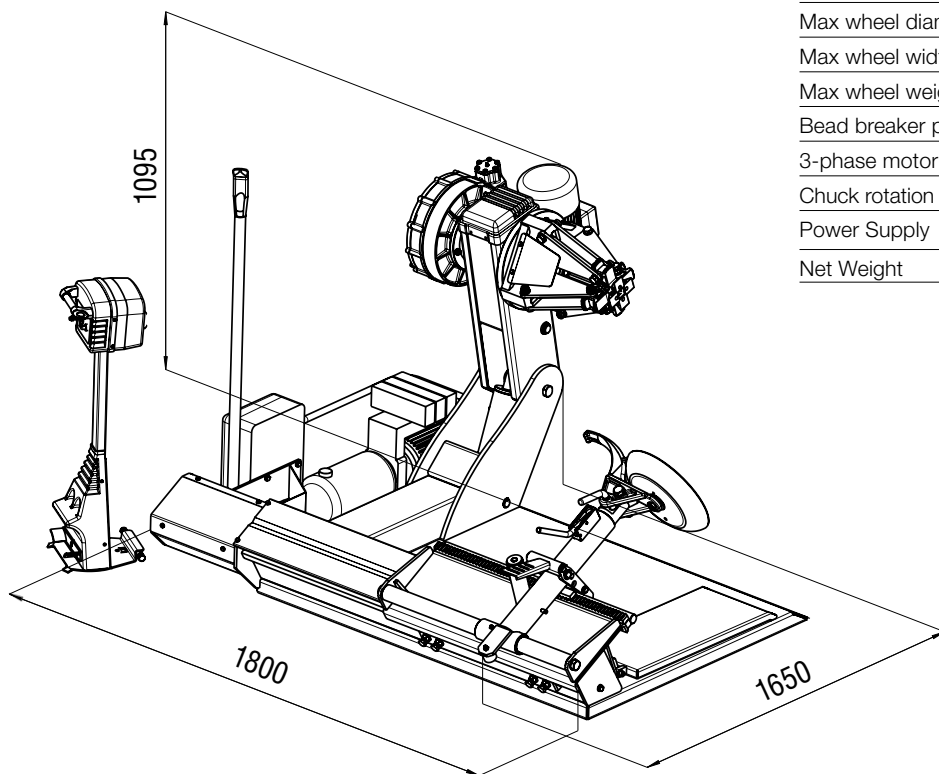

Clamping capacity	14"- 30"
Central hole minimum clamping	5" 122 mm
Max wheel diameter	65" 1640 mm
Max wheel width	34" 850 mm
Max wheel weight	2645 lbs 1200 kg
Bead breaker power in-out	25.000 N
3-phase motor	1,5 kW (2 Hp)
Chuck rotation speed	7 rpm
Power Supply	230V/3ph/50-60Hz or
Net Weight	1333 lbs 605 kg

OPTIONAL ACCESSORIES

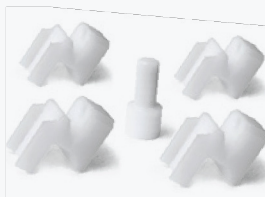

Set of 4 jaws for alloy rims



Plier for alloy rims



Ring protectors for alloy rims



Garage equipment division
CEMB USA - BL Systems Inc.
 2873 Ramsey Road
 Gainesville, GA 30501 - USA
 Phone +001 678 717 1050
 Fax +001 678 717 1056
 sales@cemb-usa.com
www.cemb-usa.com

All the data and features mentioned in this catalogue are purely for information and do not constitute any commitment on the part of our company, which reserves the right to make any and all alterations it may consider suitable without notice.